

Harman LeRoy and Jan Linklain

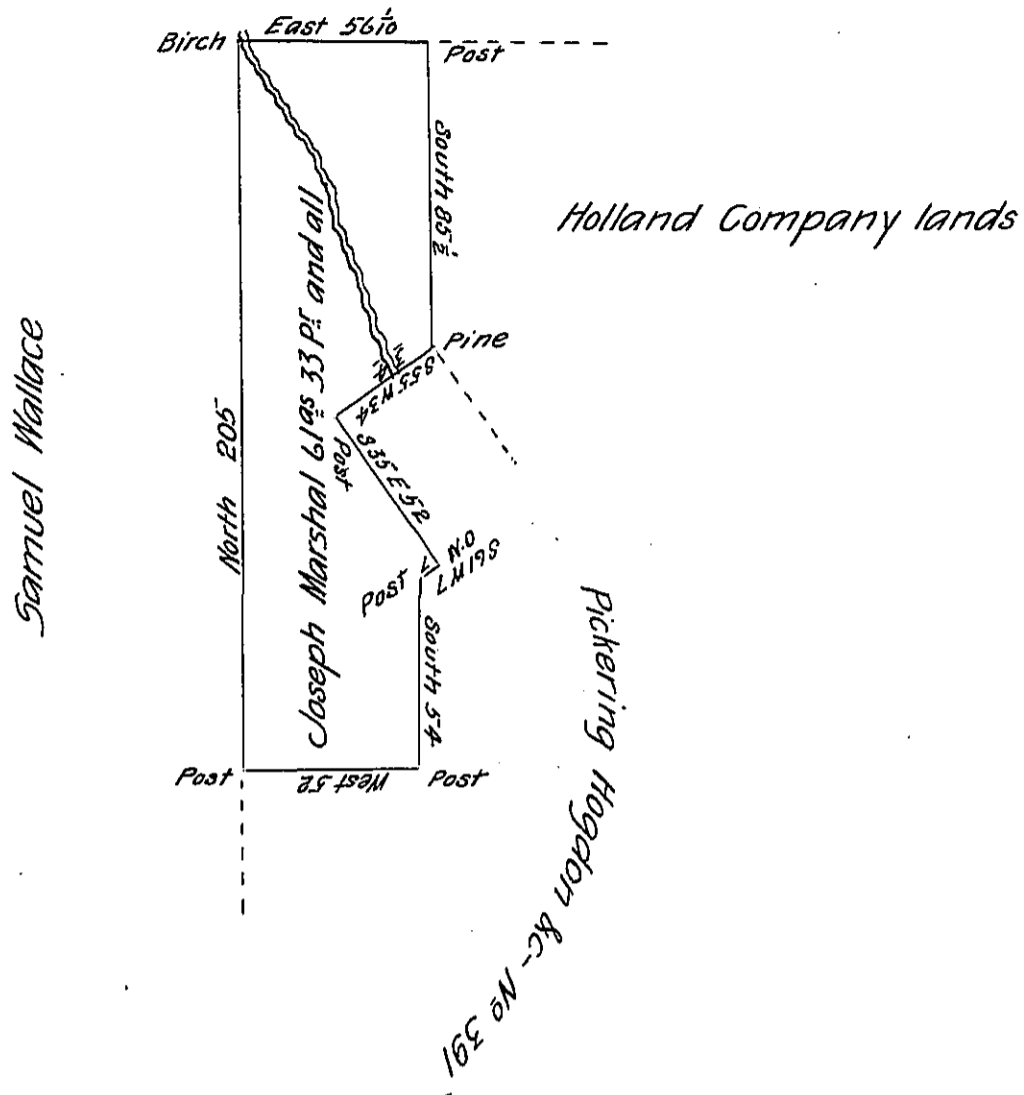

Surveyed to Joseph Marshal on the 15th day of October 1824 the above described tract of land. Containing sixty one acres thirty three perches and the allowance of six P^r Cent. Situate on the Glade Run adjoining lands of Timothy Pickering, Thomas Hogdon & C-lands of Samuel Wallace, Harman LeRoy and Jan Linklain in Wayne Township Armstrong County. in pursuance of a Warrant granted to said Joseph Marshal on the 13th day of March 1824.

Robert Richards. D.S.

To Gabriel Heister Esquire.

IN TESTIMONY that the above is a copy of the original remaining on file in the Department of Internal Affairs of Pennsylvania, made conformably to an Act of Assembly approved the 16th day of February, 1833, I have hereunto set my Hand and caused the Seal of said Department to be affixed at Harrisburg, this sixteenth day of January 1906.

Joseph R. Brown
 Secretary of Internal Affairs.